

09

TerrAria s.r.l. was founded in 1999 in Milan by the experience of a working group engaged in the development of an innovative environmental and territorial geographic information system. The company is organized in three business units: **Information Technology**, **Environmental Assessment** and **Territorial Planning** providing:

Strategic consultancy, supporting customers in the design of the decision-making process both the from the methodological and IT point of view.

Operational consultancy, providing customers the ad hoc implementation with the scientific/technical know-how and the technological structures gained and continuously updated in the complex and specialized work experiences.



TerrAria s.r.l.

Strumenti informatici e progetti
per il territorio e l'ambiente.

STITUTIONAL CUSTOMERS

- ↘ Regione Lombardia – DG Ambiente
- ↘ Regione Lombardia – DG Reti e servizi
- ↘ Regione Lombardia – DG Casa
- ↘ Regione Lombardia – Protezione Civile
- ↘ ARPA Lombardia
- ↘ Comuni/Province

CORPORATE CUSTOMER

- ↘ CESTEC
- ↘ Hillson Moran
- ↘ ARCHA
- ↘ SIAP-MICROS
- ↘ Lombardia Informatica
- ↘ Vodafone
- ↘ Fortè Italia
- ↘ Globo
- ↘ TEI
- ↘ SOCECO

RESERCH CENTER

- ↘ JRC – IES – Ispra
- ↘ CESI Ricerca
- ↘ Università di Bergamo
- ↘ Politecnico di Milano
- ↘ Università di Brescia

IT GOVERNANCE AND REPORTING

To answer the growing demand for real-time updated and synthetic data the IT business unit, through its engineering expertise, creates open source and multi-platform solutions verticalized according to customer needs.

Using service oriented application and by datawarehousing techniques, information is summarized in dashboards and executive decision support systems (DSS) or plotted on interactive geographical maps. The Web is the perfect platform and channel to delivery those services

LOCAL PLANNING & URBAN POLICY

Territorial Planning and Urban Policy BU develops control instruments to govern territory and urban area transformations.

The focus is on long term development and on environmental and economical sustainability, these goals are also achieved through the adoption of procedures for strategic evaluation designed to ensure compatibility of plans and projects

ENVIRONMENTAL ASSESSMENT

The Environmental Assessment BU estimates the environmental and energy impacts of many human activities. The division supports policy makers, at industrial and institutional levels, in defining politics for the reduction, mitigation and compensation of pollution.

The main assessment instruments are:
accounting of emissions of pollutants and greenhouse gases,
water and air pollution modeling

LOCAL PLANNING



PGT Integrati delle Terre dei Navigli (CR)

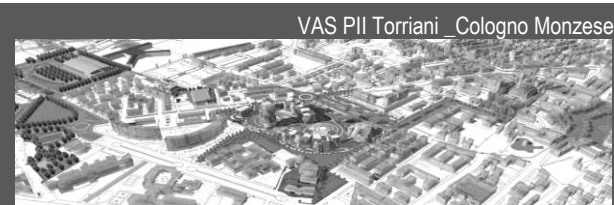

Implementation of territorial development plans and programs (local plan for the government of the territory (PGT), integrated programs for the sub-urban rehabilitation (PII), area plans ...), and environmental protection plans and programs (acoustic and air quality action plan, energy plan ...)

ENVIRONMENTAL ASSESSMENT

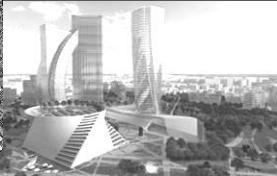
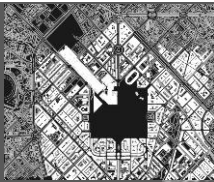

SIA CityLife



SIA Cerba

Study and assessment of environmental impacts of industrial anthropic activities (EIA) of program and plans (SEA) through quantitative assessments such as deterministic models, emission-energy balances of pollutants and greenhouse gases (CO₂), assessments of vegetational compensations

IT – GOVERNANCE AND REPORTING

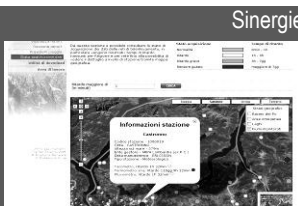

Sinergie

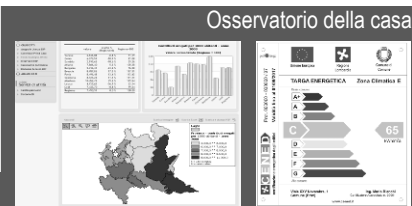
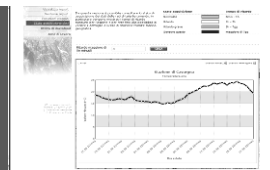

Osservatorio della casa

Operational consultancy for the development of systems, web based applications, and service-oriented architectures (SOA) useful to create and display key and detailed indicators for data monitoring and process management, using business intelligence (BI), reporting and WebGIS. Strategic consultancy for architectural and technological solutions



Via M.Gioia, 132
20125 Milano
Italia

T +39 02 870 856 55
F +39 02 973 765 69
info@terraria.it

www.terraria.it

